



DRAWINGS SCALE: 1/1

MATERIAL: Square brass wire, as per DIN, Cu Zn 37 (Except customer's priorities)

DIMENSIONS: a x l (Tenths mm.)
 a = square side
 l = Total length

FINISHING: Bur-free and carefully smoothed

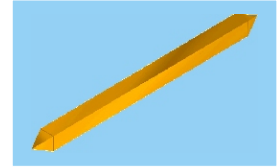

SQUARE WIRE CONTACT PINS
WITH TWO PYRAMIDAL EDGES

Square 0,64 ± 0.03 :

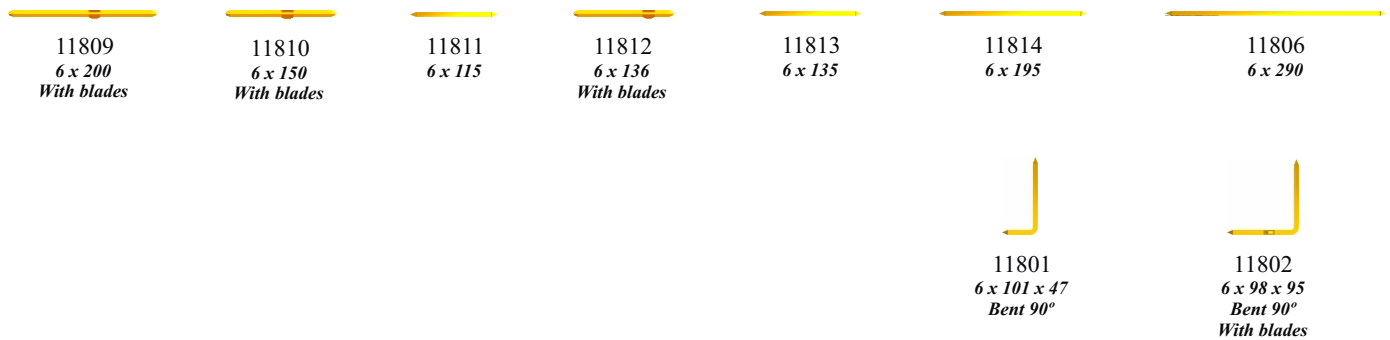

Square 1,00 ± 0.02 :



Square 1,14 ± 0.02 :

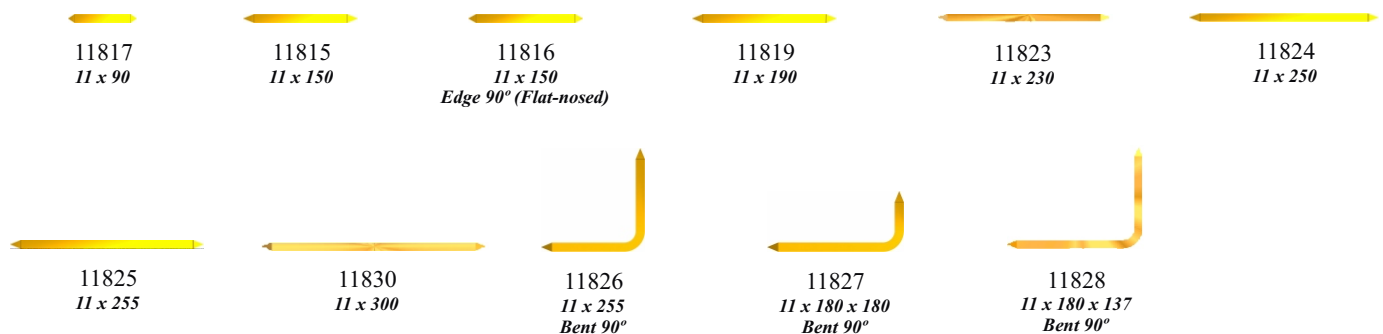

SEVERAL:

